

TOP VIEW

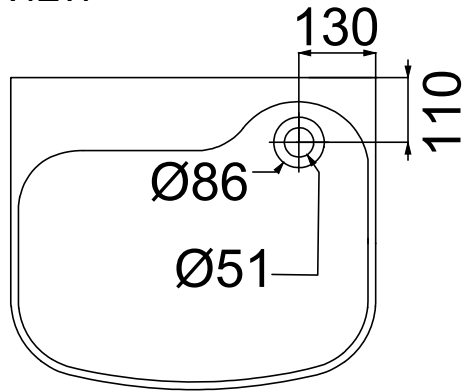

RIGHT VIEW

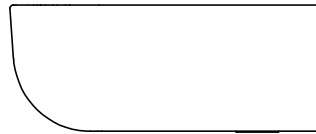

LEFT VIEW

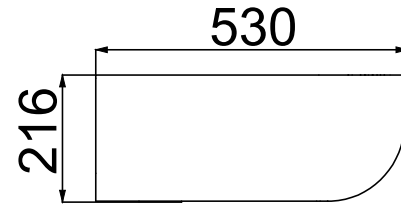

FRONT VIEW

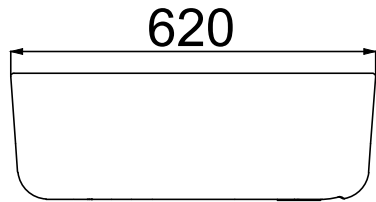

BACK VIEW

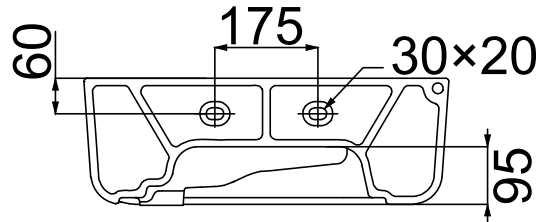

SECTION VIEW A-A



BOTTOM VIEW

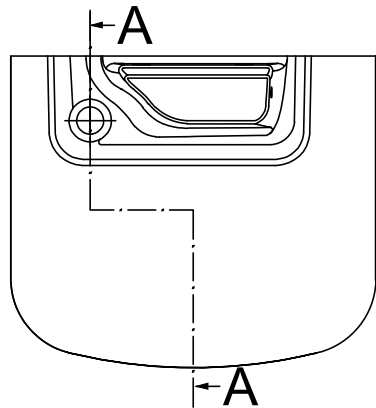

REVISIONS		
REV.	DATE	DESCRIPTION

GENTEC
 6, 20 -28 Ricketty St
 Mascot, NSW 2020
 www.gentecaustralia.com.au
 info@gentecaustralia.com.au

LAST UPDATE
07/April/2026

APPROVED BY
S.Cameron

PRODUCT CODE AND DESCRIPTION:
**SANC610B - Wall Mounted 610mm Type A Clinical Basin w/
 Nano Glazing, No Tap Hole Offset Waste No Overflow**

*This drawing is the property of
 Gentec Australia Pty Ltd*

PRODUCT RANGE:
STERISAN

MATERIAL: **Ceramic**

FINISH: **Nano-glaze**

SIZE:
A4

SCALE:
 1:1

All dimensions are in mm unless specified
 and are to be used as a guide only