

A B C D E F

40.00

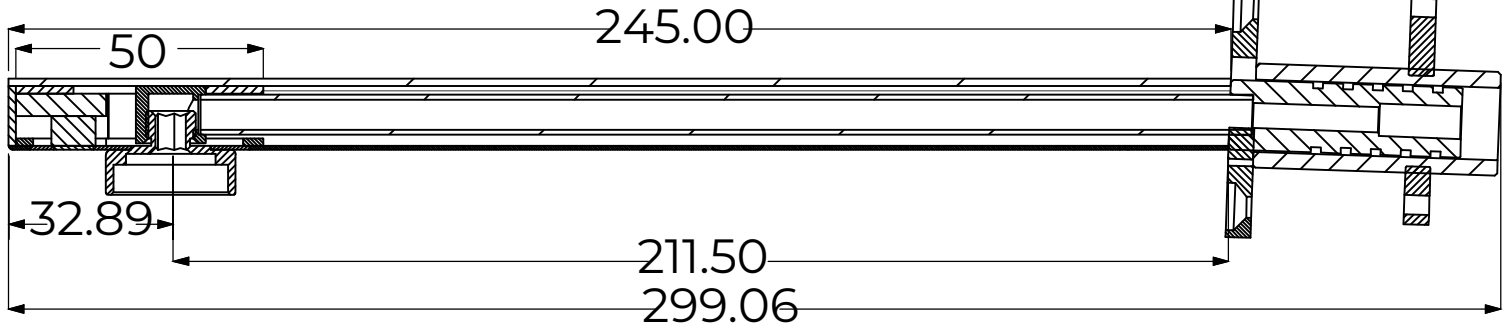
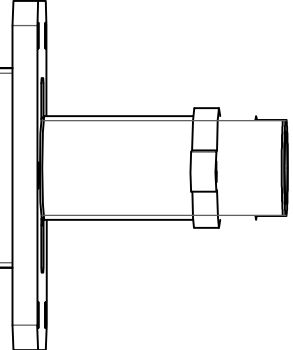
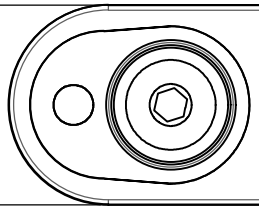

GENTEC
 6, 20 -28 Ricketty St
 Mascot, NSW 2020
 www.gentecaustralia.com.au
 info@gentecaustralia.com.au

LAST UPDATE
 12 Dec 2024

APPROVED BY
 S.C

PRODUCT CODE AND DESCRIPTION:
 PLUS2500 - SMARTEC PLUS Stainless Steel Wall Mounted Electronic Tap with Laser Sensor & Control Box

This drawing is the property of Gentec Australia Pty Ltd

PRODUCT RANGE:
PLUS

MATERIAL: **SS 304**

FINISH:

SIZE:
A4

SCALE:
NTS

Third Angle Projection AS-1100

All dimensions are in mm unless specified and are to be used as a guide only

| REVISIONS | | |
|-----------|------|-------------|
| REV. | DATE | DESCRIPTION |
| | | |
| | | |
| | | |

A B C D E F

1

2

3

4

1

2

3

4